

KC.LA3003 Kit supplied with gutter system

- 1x **EX.G** Aluminum Gutter Section
- 1x **PS003** Aluminum Downspout Section
- 1x **PS004** Aluminum 90 degree Elbow
- 1x **LA3020A** Gutter End Caps (short)
- 1x **LA3020B** Gutter End Caps (high)
- 4x **EX.GA.118** Gutter Hanger
- 1x **PS005** Aluminum Downspout Outlet
- 8x **054** Self tapping Screw #8-1/2"
- 12x **040** Self tapping Screw #8-3/4"
- 1x Elbow Bracket

Overview

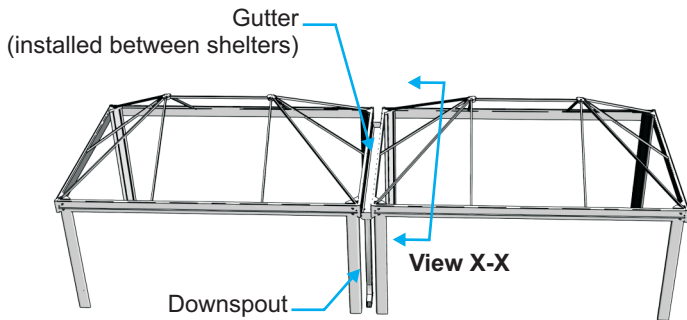

The gutter system is installed between two adjacent shelters. First determine on which side the downspout will be located then follow these steps for the gutter system installation.

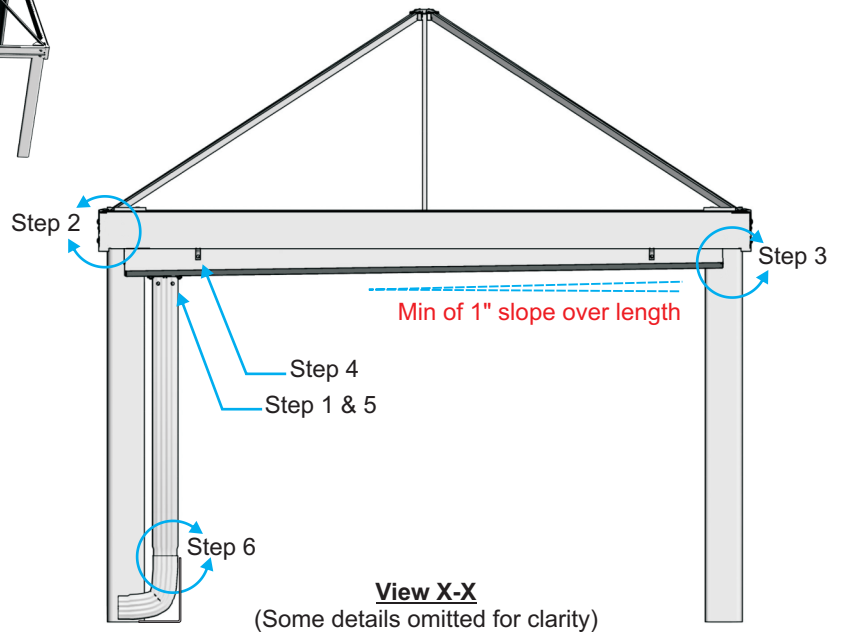

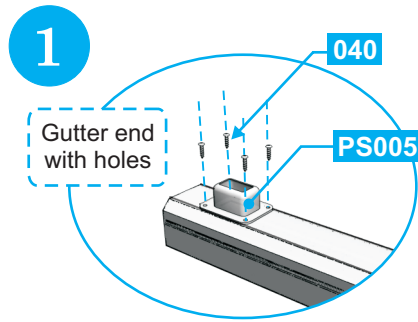

Install the downspout outlet [PS005] on the predrilled end of the gutter using metal screws [040].

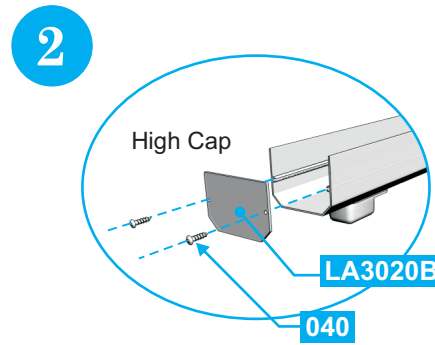

On the end of the gutter (side with downspout outlet) secure the high end cap [LA3020B] using metal screws [040].

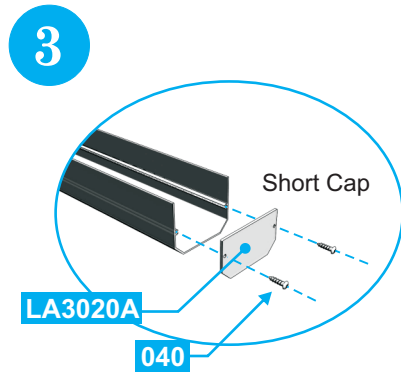

Install the short [LA3020A] cap on the other side of the gutter using metal screws [040].

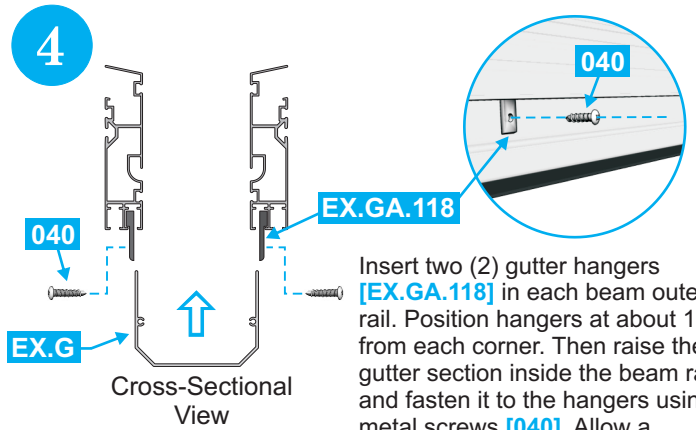

Insert two (2) gutter hangers [EX.GA.118] in each beam outer rail. Position hangers at about 12" from each corner. Then raise the gutter section inside the beam rail and fasten it to the hangers using metal screws [040]. Allow a minimum of 1" slope over the length of the gutter.

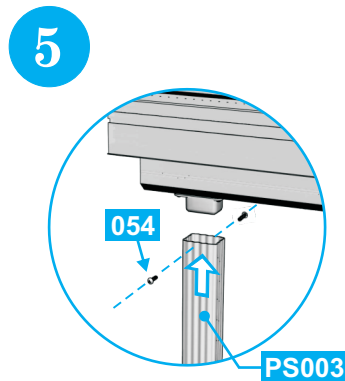

Insert the downspout section [PS003] over the outlet and fasten it with screws [054] on each side.

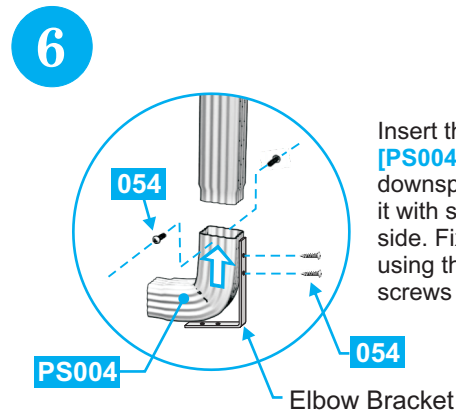

Insert the remaining elbow [PS004] on the vertical downspout section and fasten it with screws [054] on each side. Fix the elbow in place by using the angle bracket and screws [054].